

ASBESTOS ABATEMENT PROJECT DESIGN

PREPARED ESPECIALLY
FOR:

**WILL COUNTY EXECUTIVES OFFICE
302 N. CHICAGO STREET
JOLIET, IL 60432**

PROJECT LOCATION:

**FORMER WILL COUNTY COURTHOUSE
14 W. JEFFERSON STREET
JOLIET, IL 60432**

MEC PROJECT #: 22-03-223-PD

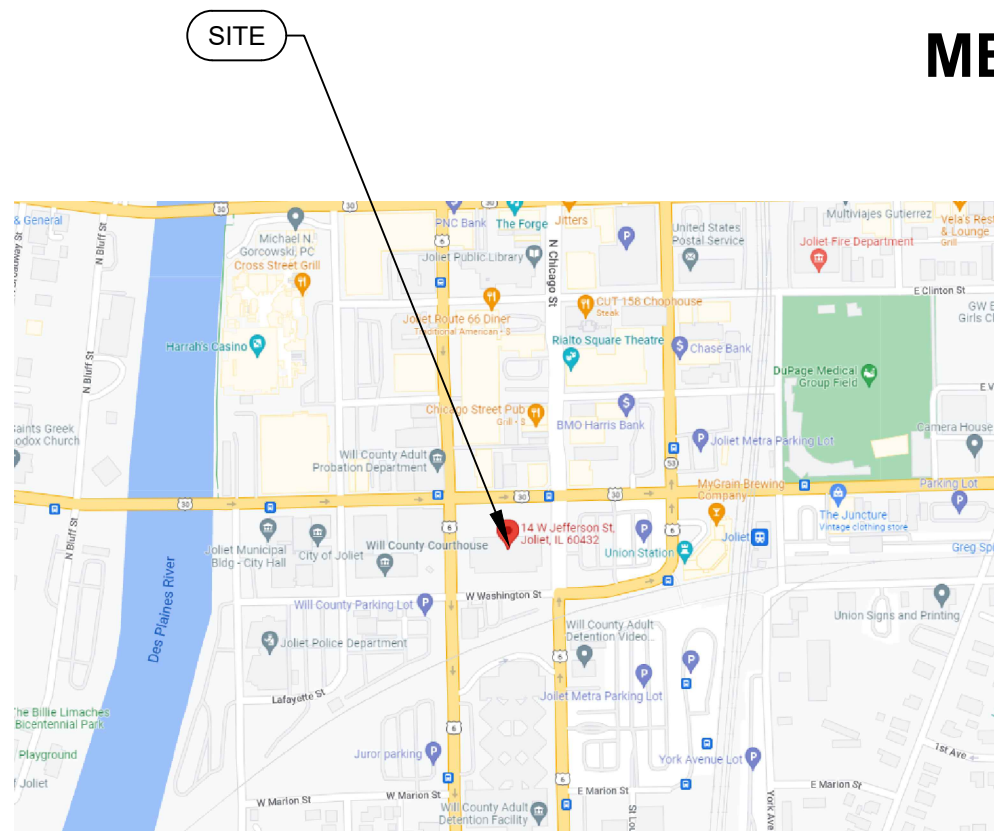

SITE LOCATION MAP
NTS



ASBESTOS ABATEMENT DRAWING INDEX

GENERAL:

- G - 0 COVER SHEET
- G - 1 SCOPE OF WORK / GENERAL NOTES
- G - 2 COVID-19 POLICY

ASBESTOS ABATEMENT PLAN:

- ASB - 1 LOWER LEVEL - ASBESTOS ABATEMENT PLAN
- ASB - 2 1ST FLOOR - ASBESTOS ABATEMENT PLAN
- ASB - 3 2ND FLOOR - ASBESTOS ABATEMENT PLAN
- ASB - 4 3RD FLOOR - ASBESTOS ABATEMENT PLAN
- ASB - 5 4TH FLOOR - ASBESTOS ABATEMENT PLAN
- ASB - 6 PENTHOUSE - ASBESTOS ABATEMENT PLAN

PROJECT TIMELINE:

- PRE-BID WALK THROUGH: MONDAY, JULY 25, 2022 @ 9:00 AM
- BID DUE DATE: TUESDAY, AUGUST 2, 2022 @ 11:30 AM
- PROJECT START: TBD
- PROJECT COMPLETION: TBD

REVIEWED BY:



Consultant:
Midwest Environmental Consulting Services, Inc.
2551 N. Bridge Street
Yorkville, IL 60560
Ph. 630.553.3989
Fax 630.553.3990
www.mec-us.com

**CONTRACTOR TO FIELD
VERIFY ALL QUANTITIES:**

Project Designer:

LIC #:

Project Location:
Former Will County Courthouse
14 W. Jefferson Street
Joliet, IL 60432

Reference Surveys:
19-10-748-INSP

Client:
Will County Executives Office
302 N. Chicago Street
Joliet, IL 60432

REVISIONS

| Number: | Date: | Rev. By: |
|---------|-------|----------|
| | | |
| | | |
| | | |
| | | |

Drawn By: **JWR** Scale: **NTS**

Date: **7/25/22**

Project No: **22-03-223-PD**

Dwg. No: **G - 0**

COVER SHEET

SCOPE OF WORK:

The Contractor shall follow all applicable IDPH, EPA, and OSHA rules and regulations. The Contractor shall install plywood barriers and/or lock doors with sufficient signage to isolate the building in order to prevent access by unauthorized personnel. Barriers shall be constructed in accordance with IDPH rules and regulations, Title 77 of the Illinois Administrative Code (77IAC), Section 855.430.

The contractor shall be responsible for moving all moveable objects from rooms where abatement is scheduled. The contractor may move items to areas where abatement will not take place for storage.

The owner will not accept any change orders based on the contractor's failure to identify suspect materials. The contractor shall return to the project site to abate any materials that may be uncovered during demolition at no additional cost to the owner.

Contractor shall provide all worker paperwork to MEC's on-site Project Manager at the beginning of the shift on the first day of the project. If additional workers arrive during the duration of the project, their paperwork shall also be provided to the MEC Project Manager. For Asbestos Workers and Supervisors, this includes copies of the current IDPH license, training certificate, physical, and fit test for each person. All persons involved shall have his/her IDPH "hard card" license on-site each and every day said person is on-site. All workers who do not provide the required documentation shall not be admitted to the project site by the MEC Project Manager.

Contractor shall be responsible for removing all asbestos containing materials known or unknown from the building. The contractor shall be required to remove ceramic tile (multiple layers), carpet, computer floors, contaminated leveling compound, asbestos containing floor tile, mastic and residual mastic, duct insulation transite, and sprayed on fire proofing utilizing gross removal methods within a full containment work area as identified on the accompanying drawings. The contractor may remove fiberglass insulation or protect fiberglass insulation from contamination. All asbestos thermal system insulation located in the building known or unknown is required to be abated by the abatement contractor.

Full containment work areas shall consist of critical seals, one layer of 4-mil poly on the walls and ceilings. One layer of 6-mil poly shall be installed on the floors. An attached 3-chamber decon and 2-chamber waste-out shall be constructed at the entry to each full containment work area.

Contractor is responsible for all demolition to access all chases, plumbing walls, steel ceilings, plaster ceilings, flooring and walls. Contractor shall provide temp board up in areas where transite has been removed. Contractor shall abate all asbestos containing materials from the building known or unknown.

The Contractor shall install 7/16" plywood or equivalent over one layer of six mil poly and then place two additional layers of six mil poly over the 7/16" plywood underneath the decon unit in the work areas to protect the flooring from damage. Any damage to the existing flooring system shall be repaired or replaced at the contractor's expense.

The Contractor shall provide a manometer for the full containment work area to ensure that a negative pressure of 0.02" w.c. is maintained throughout the duration of the project. All negative air exhaust tubing shall be vented outside the work area.

All waste shall be adequately wet and double-bagged. Waste containers shall be labeled and leak-proof. All waste with sharp-edged components (e.g. nails, screws, metal lath, floor tile, etc.) shall be placed into drums for disposal. All equipment and double-bagged/labeled waste shall be transported from the work area directly to an enclosed, lockable, signed and poly-lined dumpster. All double-bagged and labeled waste shall be transported from the work area in a covered gondola. No waste shall be left within the building overnight.

All electrical systems shall be shut down and locked out. All electrical power within the work areas shall be "ground-fault protected" utilizing Ground Fault Circuit Interrupters. The Contractor is required to handle all electrical shut downs. Temporary lighting is the Contractor's responsibility and shall be provided as necessary.

The owner will assist the Contractor with electrical shut downs and HVAC isolation within the work area. The building owner shall be responsible for maintaining appropriate life safety code requirements, including fire protection, for the building for the duration of the project.

Clearance is to be by aggressive PCM and will follow requirements defined in 77IAC, Sections 855.170 (b)(c)(d) and 855.470.

NOTES - GENERAL

1. Contractor is required to visit the project site in order to submit a bid.
2. Drawing identifies the scope of work and is identified as "WORK AREA".
3. Work will be completed following all applicable requirements.
4. The Owner will not accept any change orders based on the Contractor's failure to recognize unique conditions.
5. All permits and fees that need to be filed, are the responsibility of the Contractor. A copy of these permits and receipts shall be supplied to the Owner's representative prior to start of work.
6. The replacement of the abated materials is not of this contract.
7. Contractor shall supply a licensed electrician to hook up electrical equipment if need be.
8. Contractor to use only IDPH-licensed workers.
9. Contractor's IDPH-licensed supervisor must be on site at all times.
10. All negative air shall be exhausted outside the building.
11. Contractor shall be responsible for supplying adequate protection for workers.
12. Contractor shall comply with applicable building and safety requirements.
13. Walk-off mats shall be required at all entrances to work areas.

| SCOPE REVIEW | | |
|--------------|-----------|------|
| INITIAL | SIGNATURE | DATE |
| | | |
| | | |
| | | |
| | | |
| | | |
| | | |
| | | |
| | | |
| | | |
| | | |



Consultant:
Midwest Environmental Consulting Services, Inc.
 2551 N. Bridge Street
 Yorkville, IL 60560
 Ph. 630.553.3989
 Fax 630.553.3990
 www.mec-us.com

CONTRACTOR TO FIELD VERIFY ALL QUANTITIES:

Project Designer:

LIC #:

Project Location:
 Former Will County Courthouse
 14 W. Jefferson Street
 Joliet, IL 60432

Reference Surveys:
 19-10-748-INSP

Client:
 Will County Executives Office
 302 N. Chicago Street
 Joliet, IL 60432

REVISIONS

| Number: | Date: | Rev. By: |
|---------|-------|----------|
| | | |
| | | |
| | | |
| | | |

Drawn By: **JWR** Scale: **NTS**

Date: **7/25/22**

Project No: **22-03-223-PD**









Dwg. No: **G - 1**

SCOPE OF WORK / GENERAL NOTES

GENERAL ASBESTOS ABATEMENT NOTES:

1. CONTRACTOR SHALL VERIFY ALL CONDITIONS AND DIMENSIONS IN THE FIELD.
2. CONTRACTOR SHALL CHAIN AND LOCK DOOR OR INSTALL SEPARATION BARRIERS TO PREVENT ACCESS BY UNAUTHORIZED PERSONNEL TO THE WORK AREA.
3. NEGATIVE AIR SHALL BE EXHAUSTED OUTSIDE THE WORK AREA.
4. FULL CONTAINMENT SHALL INCLUDE CRITICAL SEALS, ONE LAYER OF 4-MIL POLY ON THE WALLS, AND ONE LAYER OF 6-MIL POLY ON THE CEILING.
5. CONTRACTOR SHALL INSTALL AN ATTACHED 3-CHAMBER DECON TO THE FULL CONTAINMENT WORK AREA.
6. CONTRACTOR SHALL INSTALL AN ATTACHED 2-CHAMBER WASTE-OUT TO THE FULL CONTAINMENT WORK AREA.
7. THE CONTRACTOR SHALL REMOVE ASBESTOS CONTAINING MATERIAL UTILIZING GROSS REMOVAL METHODS WITHIN A FULL CONTAINMENT WORK AREA.

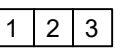
ABATEMENT LEGEND:

-  LOCATION OF ACM FLOOR TILE & MASTIC
-  LOCATION OF ACM SPRAY-APPLIED FIRE PROOFING
-  LOCATION OF KNOWN ACM TSI
-  LOCATION OF ACM THERMAL DUCT INSULATION
-  FULL CONTAINMENT AREA
-  CHAIN AND LOCK DOORS
-  SEPARATION BARRIER
-  3-CHAMBER DECON
-  2-CHAMBER WASTE-OUT
-  NEGATIVE AIR

LOOK ABOVE ALL STEEL CEILINGS AT ACCESS POINTS AND ABATE ALL TSI KNOWN/UNKNOWN

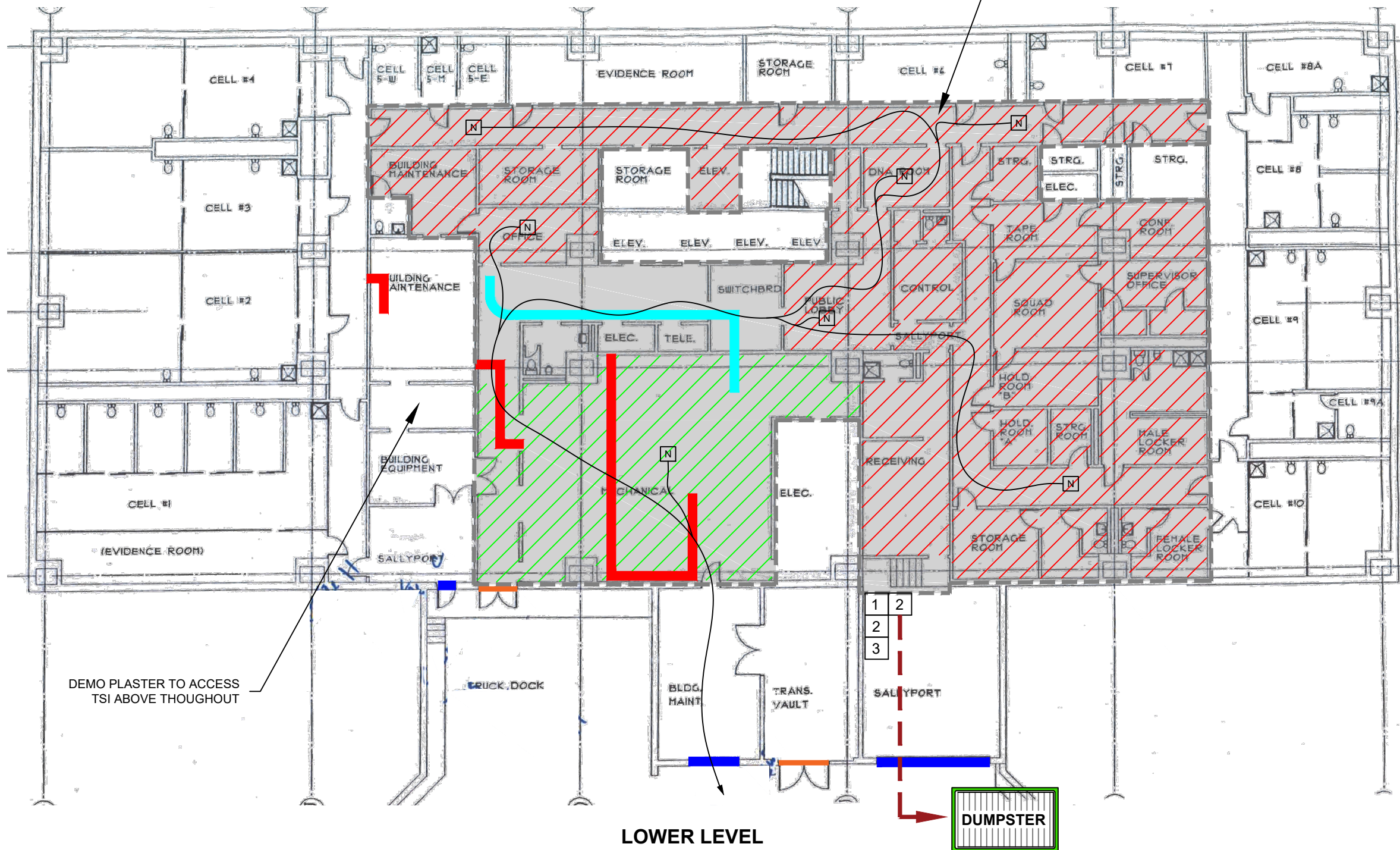

LOWER LEVEL

DUMPSTER



Consultant:
Midwest Environmental Consulting Services, Inc.
 2551 N. Bridge Street
 Yorkville, IL 60560
 Ph. 630.553.3989
 Fax 630.553.3990
 www.mec-us.com

CONTRACTOR TO FIELD VERIFY ALL QUANTITIES:

Project Designer:

LIC #:

Project Location:
 Former Will County Courthouse
 14 W. Jefferson Street
 Joliet, IL 60432

Reference Surveys:
 19-10-748-INSP

Client:
 Will County Executives Office
 302 N. Chicago Street
 Joliet, IL 60432

REVISIONS

| Number: | Date: | Rev. By: |
|---------|-------|----------|
| | | |
| | | |
| | | |
| | | |

Drawn By: **JWR** Scale: **NTS**

Date: **7/25/22**

Project No: **22-03-223-PD**





Dwg. No: **ASB - 1**

LOWER LEVEL - ASBESTOS ABATEMENT PLAN

GENERAL ASBESTOS ABATEMENT NOTES:

1. CONTRACTOR SHALL VERIFY ALL CONDITIONS AND DIMENSIONS IN THE FIELD.
2. CONTRACTOR SHALL CHAIN AND LOCK DOOR OR INSTALL SEPARATION BARRIERS TO PREVENT ACCESS BY UNAUTHORIZED PERSONNEL TO THE WORK AREA.
3. NEGATIVE AIR SHALL BE EXHAUSTED OUTSIDE THE WORK AREA.
4. FULL CONTAINMENT SHALL INCLUDE CRITICAL SEALS, ONE LAYER OF 4-MIL POLY ON THE WALLS, AND ONE LAYER OF 6-MIL POLY ON THE CEILING.
5. CONTRACTOR SHALL INSTALL AN ATTACHED 3-CHAMBER DECON TO THE FULL CONTAINMENT WORK AREA.
6. CONTRACTOR SHALL INSTALL AN ATTACHED 1-CHAMBER AIR-LOCK.
7. THE CONTRACTOR SHALL REMOVE ASBESTOS CONTAINING MATERIAL UTILIZING GROSS REMOVAL METHODS WITHIN A FULL CONTAINMENT WORK AREA.

ABATEMENT LEGEND:

-  LOCATION OF ACM FLOOR TILE, CARPET, AND MASTIC
-  FULL CONTAINMENT AREA
-  CHAIN AND LOCK DOORS
-  SEPARATION BARRIER
- | | | |
|---|---|---|
| 1 | 2 | 3 |
|---|---|---|

 3-CHAMBER DECON
- | |
|---|
| 1 |
|---|

 1-CHAMBER AIR-LOCK
- | |
|---|
| N |
|---|

 NEGATIVE AIR



Consultant:
Midwest Environmental Consulting Services, Inc.
 2551 N. Bridge Street
 Yorkville, IL 60560
 Ph. 630.553.3989
 Fax 630.553.3990
 www.mec-us.com

CONTRACTOR TO FIELD VERIFY ALL QUANTITIES:

Project Designer:

LIC #:

Project Location:
 Former Will County Courthouse
 14 W. Jefferson Street
 Joliet, IL 60432

Reference Surveys:
 19-10-748-INSP

Client:
 Will County Executives Office
 302 N. Chicago Street
 Joliet, IL 60432

REVISIONS

| Number: | Date: | Rev. By: |
|---------|-------|----------|
| | | |
| | | |
| | | |
| | | |

Drawn By: **JWR** Scale: **NTS**

Date: **7/25/22**

Project No: **22-03-223-PD**

Dwg. No: **ASB - 2**

1ST FLOOR - ASBESTOS ABATEMENT PLAN

CONTRACTOR TO DEMO CEILINGS & PIPE CHASES TO ACCESS ALL TSI KNOWN/UNKNOWN THROUGHOUT

POTENTIAL FOR MULTIPLE LAYERS OF FLOORING THROUGHOUT

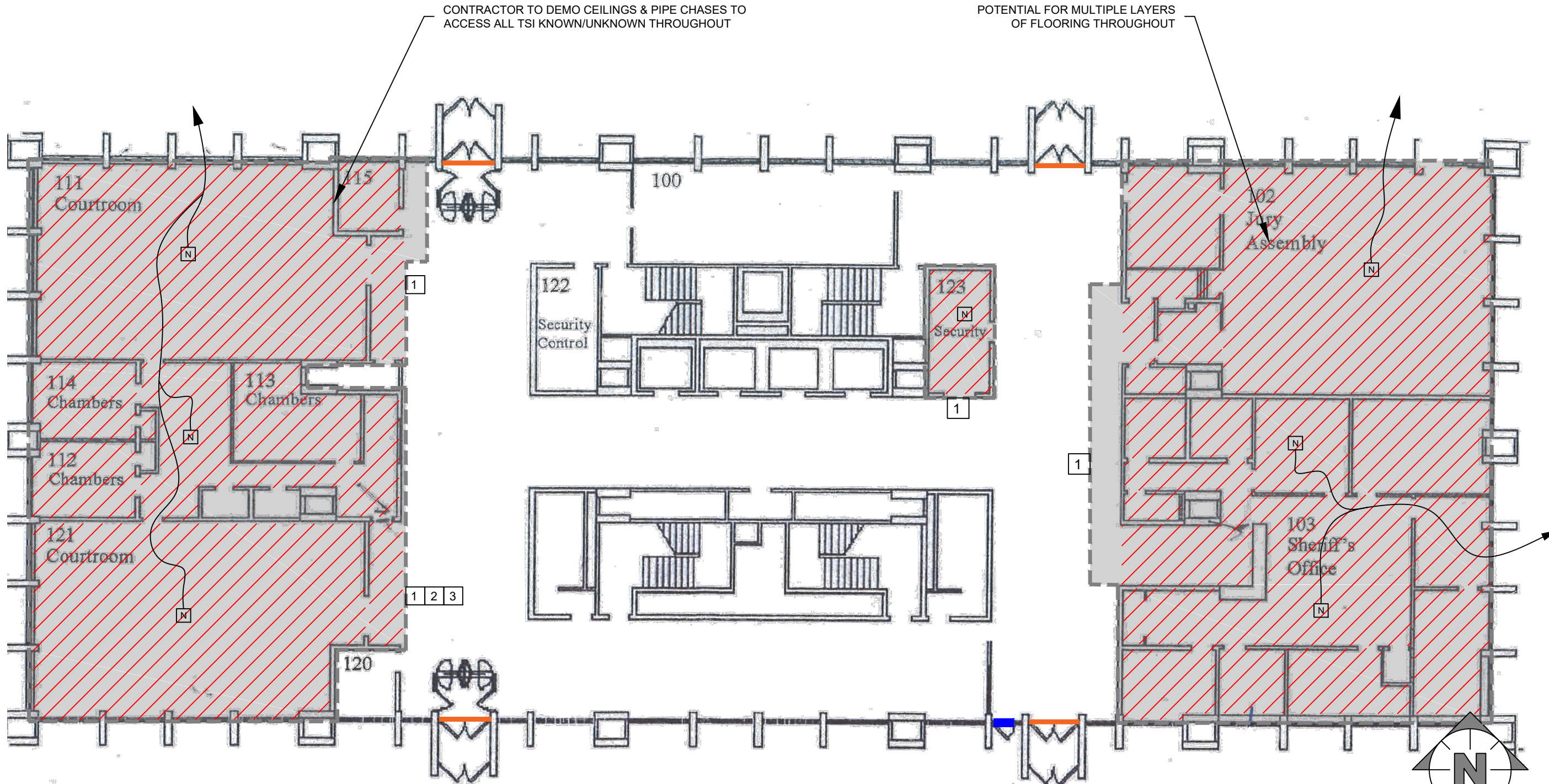





1ST FLOOR

GENERAL ASBESTOS ABATEMENT NOTES:

1. CONTRACTOR SHALL VERIFY ALL CONDITIONS AND DIMENSIONS IN THE FIELD.
2. CONTRACTOR SHALL CHAIN AND LOCK DOOR OR INSTALL SEPARATION BARRIERS TO PREVENT ACCESS BY UNAUTHORIZED PERSONNEL TO THE WORK AREA.
3. NEGATIVE AIR SHALL BE EXHAUSTED OUTSIDE THE WORK AREA.
4. FULL CONTAINMENT SHALL INCLUDE CRITICAL SEALS, ONE LAYER OF 4-MIL POLY ON THE WALLS, AND ONE LAYER OF 6-MIL POLY ON THE CEILING.
5. CONTRACTOR SHALL INSTALL AN ATTACHED 3-CHAMBER DECON TO THE FULL CONTAINMENT WORK AREA.
6. CONTRACTOR SHALL INSTALL AN ATTACHED 2-CHAMBER WASTE-OUT TO THE FULL CONTAINMENT WORK AREA.
7. THE CONTRACTOR SHALL REMOVE ASBESTOS CONTAINING MATERIAL UTILIZING GROSS REMOVAL METHODS WITHIN A FULL CONTAINMENT WORK AREA.

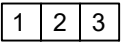
ABATEMENT LEGEND:

-  LOCATION OF ACM FLOOR TILE (CERAMIC & VINYL) AND MASTIC
-  FULL CONTAINMENT AREA
-  3-CHAMBER DECON
-  2-CHAMBER WASTE-OUT
-  NEGATIVE AIR

MULTIPLE LAYERS OF CERAMIC TILE, FLOORING, & MASTIC THROUGHOUT ALL FLOORS

CONTRACTOR TO DEMO CEILINGS & PIPE CHASES TO ACCESS ALL TSI KNOWN/UNKNOWN THROUGHOUT

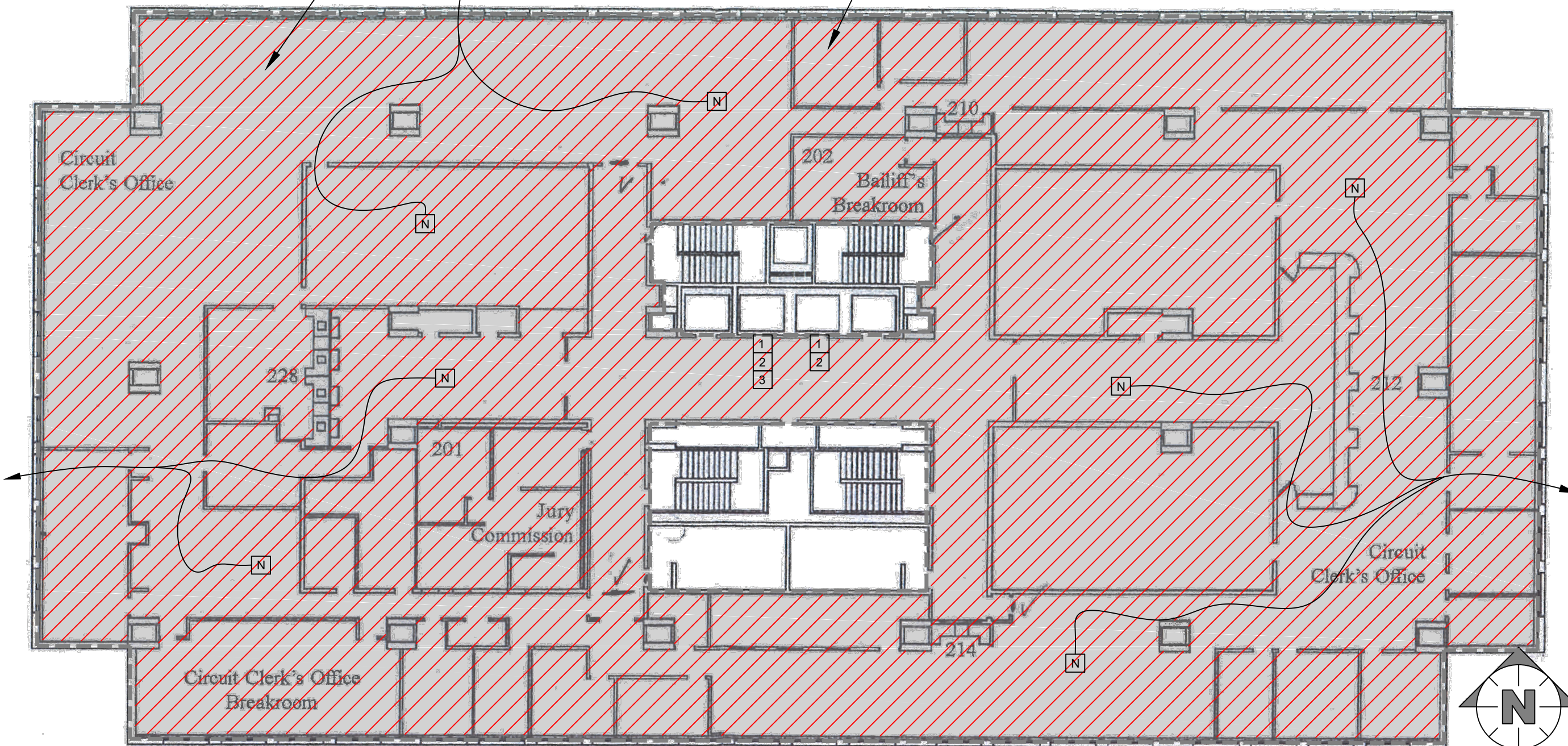

2ND FLOOR



Consultant:
Midwest Environmental Consulting Services, Inc.
 2551 N. Bridge Street
 Yorkville, IL 60560
 Ph. 630.553.3989
 Fax 630.553.3990
 www.mec-us.com

CONTRACTOR TO FIELD VERIFY ALL QUANTITIES:

Project Designer:

LIC #:

Project Location:
 Former Will County Courthouse
 14 W. Jefferson Street
 Joliet, IL 60432

Reference Surveys:
 19-10-748-INSP

Client:
 Will County Executives Office
 302 N. Chicago Street
 Joliet, IL 60432

REVISIONS

| Number: | Date: | Rev. By: |
|---------|-------|----------|
| | | |
| | | |
| | | |
| | | |

Drawn By: **JWR** Scale: **NTS**

Date: **7/25/22**

Project No: **22-03-223-PD**





Dwg. No: **ASB - 3**

2ND FLOOR - ASBESTOS ABATEMENT PLAN

GENERAL ASBESTOS ABATEMENT NOTES:

1. CONTRACTOR SHALL VERIFY ALL CONDITIONS AND DIMENSIONS IN THE FIELD.
2. CONTRACTOR SHALL CHAIN AND LOCK DOOR OR INSTALL SEPARATION BARRIERS TO PREVENT ACCESS BY UNAUTHORIZED PERSONNEL TO THE WORK AREA.
3. NEGATIVE AIR SHALL BE EXHAUSTED OUTSIDE THE WORK AREA.
4. FULL CONTAINMENT SHALL INCLUDE CRITICAL SEALS, ONE LAYER OF 4-MIL POLY ON THE WALLS, AND ONE LAYER OF 6-MIL POLY ON THE CEILING.
5. CONTRACTOR SHALL INSTALL AN ATTACHED 3-CHAMBER DECON TO THE FULL CONTAINMENT WORK AREA.
6. CONTRACTOR SHALL INSTALL AN ATTACHED 2-CHAMBER WASTE-OUT TO THE FULL CONTAINMENT WORK AREA.
7. THE CONTRACTOR SHALL REMOVE ASBESTOS CONTAINING MATERIAL UTILIZING GROSS REMOVAL METHODS WITHIN A FULL CONTAINMENT WORK AREA.

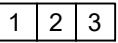
ABATEMENT LEGEND:

-  LOCATION OF ACM FLOOR TILE, CARPET, AND MASTIC
-  FULL CONTAINMENT AREA
-  3-CHAMBER DECON
-  2-CHAMBER WASTE-OUT
-  NEGATIVE AIR



Consultant:
Midwest Environmental Consulting Services, Inc.
 2551 N. Bridge Street
 Yorkville, IL 60560
 Ph. 630.553.3989
 Fax 630.553.3990
 www.mec-us.com

CONTRACTOR TO FIELD VERIFY ALL QUANTITIES:

Project Designer:

LIC #:

Project Location:
 Former Will County Courthouse
 14 W. Jefferson Street
 Joliet, IL 60432

Reference Surveys:
 19-10-748-INSP

Client:
 Will County Executives Office
 302 N. Chicago Street
 Joliet, IL 60432

REVISIONS

| Number: | Date: | Rev. By: |
|---------|-------|----------|
| | | |
| | | |
| | | |

Drawn By: **JWR** Scale: **NTS**

Date: **7/25/22**

Project No: **22-03-223-PD**

Dwg. No: **ASB - 4**

CONTRACTOR TO DEMO CEILINGS & PIPE CHASES TO ACCESS ALL TSI KNOWN/UNKNOWN THROUGHOUT

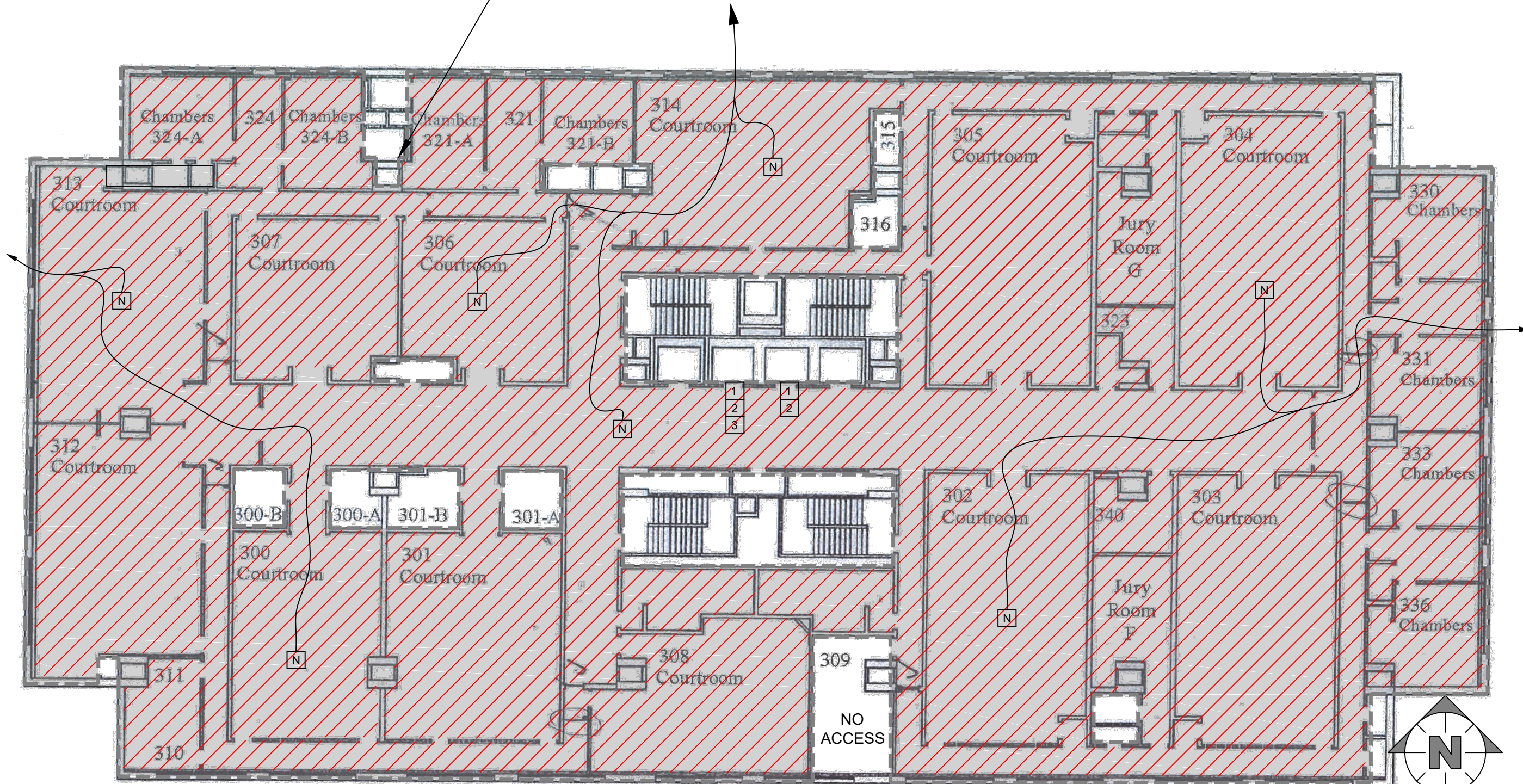

3RD FLOOR

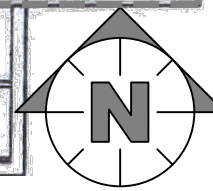





3RD FLOOR - ASBESTOS ABATEMENT PLAN

GENERAL ASBESTOS ABATEMENT NOTES:

1. CONTRACTOR SHALL VERIFY ALL CONDITIONS AND DIMENSIONS IN THE FIELD.
2. CONTRACTOR SHALL CHAIN AND LOCK DOOR OR INSTALL SEPARATION BARRIERS TO PREVENT ACCESS BY UNAUTHORIZED PERSONNEL TO THE WORK AREA.
3. NEGATIVE AIR SHALL BE EXHAUSTED OUTSIDE THE WORK AREA.
4. FULL CONTAINMENT SHALL INCLUDE CRITICAL SEALS, ONE LAYER OF 4-MIL POLY ON THE WALLS, AND ONE LAYER OF 6-MIL POLY ON THE CEILING.
5. CONTRACTOR SHALL INSTALL AN ATTACHED 3-CHAMBER DECON TO THE FULL CONTAINMENT WORK AREA.
6. CONTRACTOR SHALL INSTALL AN ATTACHED 2-CHAMBER WASTE-OUT TO THE FULL CONTAINMENT WORK AREA.
7. THE CONTRACTOR SHALL REMOVE ASBESTOS CONTAINING MATERIAL UTILIZING GROSS REMOVAL METHODS WITHIN A FULL CONTAINMENT WORK AREA.

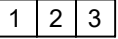
ABATEMENT LEGEND:

-  LOCATION OF ACM CARPET AND MASTIC
-  FULL CONTAINMENT AREA
-  3-CHAMBER DECON
-  2-CHAMBER WASTE-OUT
-  NEGATIVE AIR



Consultant:
Midwest Environmental Consulting Services, Inc.
 2551 N. Bridge Street
 Yorkville, IL 60560
 Ph. 630.553.3989
 Fax 630.553.3990
 www.mec-us.com

CONTRACTOR TO FIELD VERIFY ALL QUANTITIES:

Project Designer:

LIC #:

Project Location:
 Former Will County Courthouse
 14 W. Jefferson Street
 Joliet, IL 60432

Reference Surveys:
 19-10-748-INSP

Client:
 Will County Executives Office
 302 N. Chicago Street
 Joliet, IL 60432

REVISIONS

| Number: | Date: | Rev. By: |
|---------|-------|----------|
| | | |
| | | |
| | | |

Drawn By: **JWR** Scale: **NTS**

Date: **7/25/22**

Project No: **22-03-223-PD**

Dwg. No: **ASB - 5**

4TH FLOOR - ASBESTOS ABATEMENT PLAN

CONTRACTOR TO DEMO CEILINGS & PIPE CHASES TO ACCESS ALL TSI KNOWN/UNKNOWN THROUGHOUT

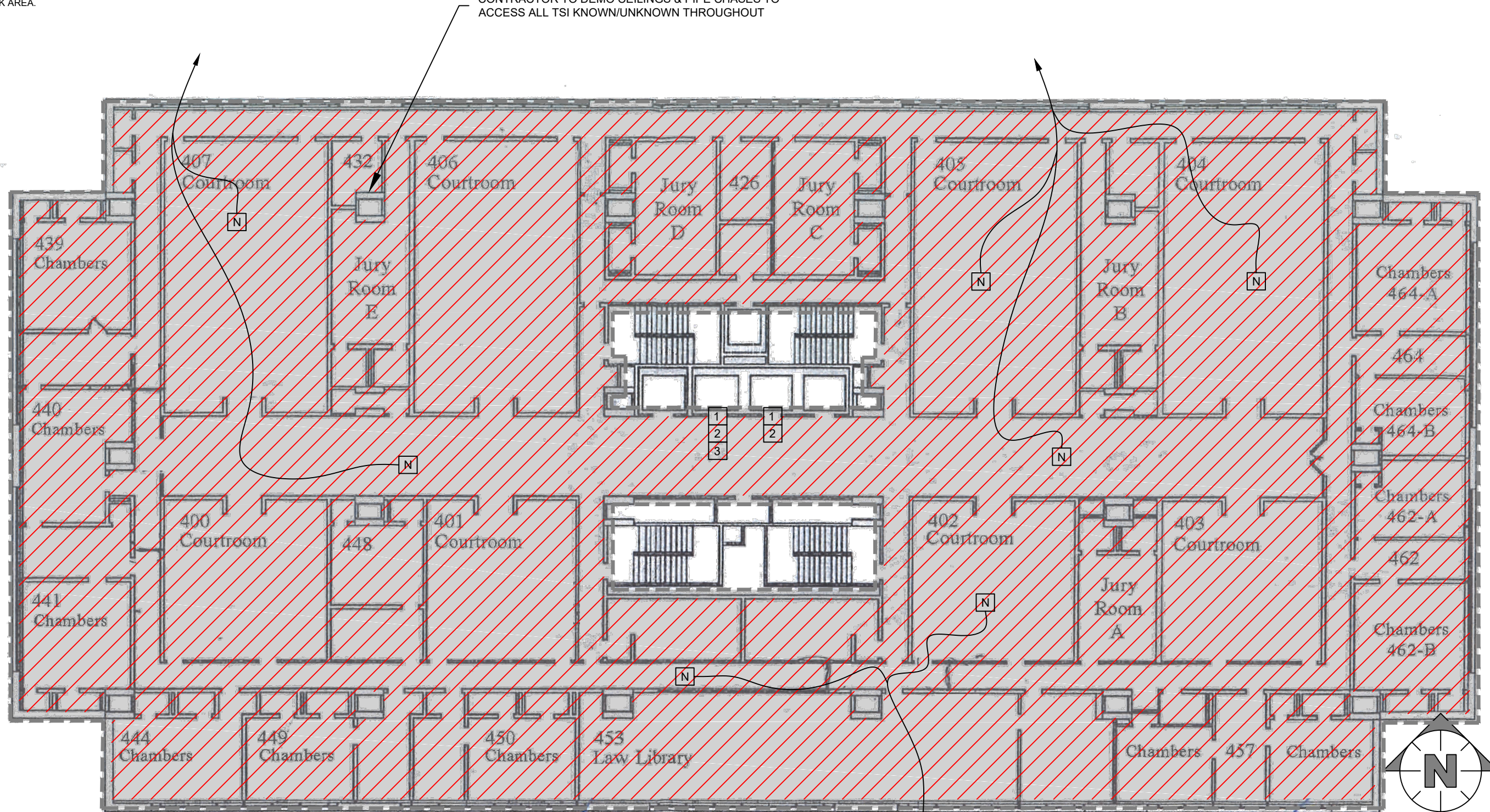



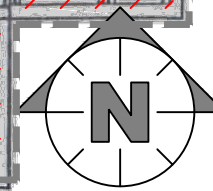



4TH FLOOR



GENERAL ASBESTOS ABATEMENT NOTES:

1. CONTRACTOR SHALL VERIFY ALL CONDITIONS AND DIMENSIONS IN THE FIELD.
2. CONTRACTOR SHALL CHAIN AND LOCK DOOR OR INSTALL SEPARATION BARRIERS TO PREVENT ACCESS BY UNAUTHORIZED PERSONNEL TO THE WORK AREA.
3. NEGATIVE AIR SHALL BE EXHAUSTED OUTSIDE THE WORK AREA.
4. FULL CONTAINMENT SHALL INCLUDE CRITICAL SEALS, ONE LAYER OF 4-MIL POLY ON THE WALLS, AND ONE LAYER OF 6-MIL POLY ON THE CEILING.
5. CONTRACTOR SHALL INSTALL AN ATTACHED 3-CHAMBER DECON TO THE FULL CONTAINMENT WORK AREA.
6. CONTRACTOR SHALL INSTALL AN ATTACHED 2-CHAMBER WASTE-OUT TO THE FULL CONTAINMENT WORK AREA.
7. THE CONTRACTOR SHALL REMOVE ASBESTOS CONTAINING MATERIAL UTILIZING GROSS REMOVAL METHODS WITHIN A FULL CONTAINMENT WORK AREA.

ABATEMENT LEGEND:

-  LOCATION OF ACM THERMAL SYSTEMS INSULATION
-  LOCATION OF ACM TRANSITE PANELS
-  FULL CONTAINMENT AREA
-  3-CHAMBER DECON
-  2-CHAMBER WASTE-OUT
-  NEGATIVE AIR

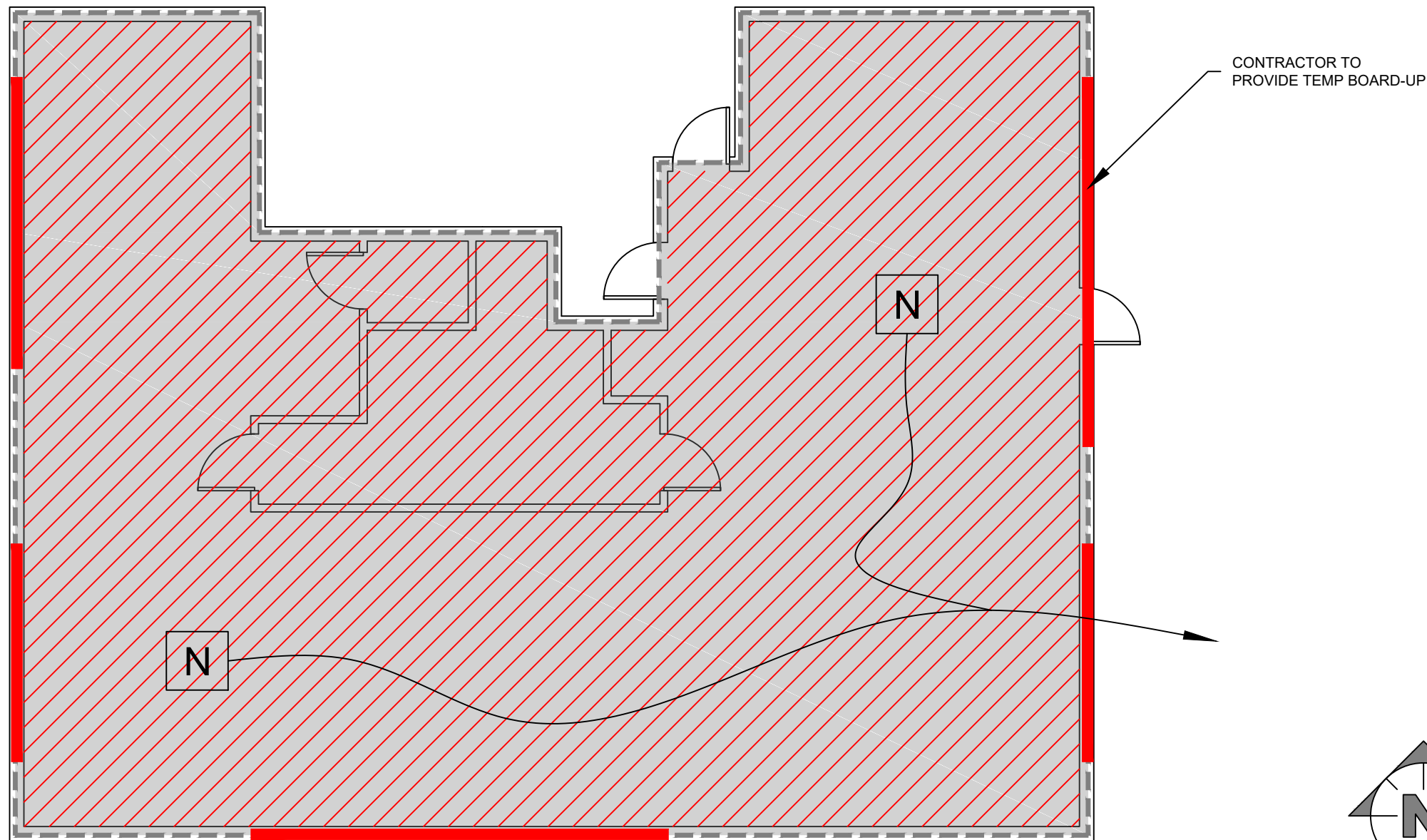

PENTHOUSE

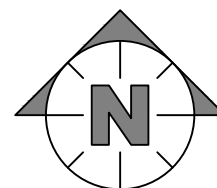

Consultant:
Midwest Environmental Consulting Services, Inc.
 2551 N. Bridge Street
 Yorkville, IL 60560
 Ph. 630.553.3989
 Fax 630.553.3990
 www.mec-us.com

CONTRACTOR TO FIELD VERIFY ALL QUANTITIES:

Project Designer:

LIC #:

Project Location:
 Former Will County Courthouse
 14 W. Jefferson Street
 Joliet, IL 60432

Reference Surveys:
 19-10-748-INSP

Client:
 Will County Executives Office
 302 N. Chicago Street
 Joliet, IL 60432

REVISIONS

| Number: | Date: | Rev. By: |
|---------|-------|----------|
| | | |
| | | |
| | | |
| | | |

Drawn By: **JWR** Scale: **NTS**

Date: **7/25/22**

Project No: **22-03-223-PD**

Dwg. No: **ASB - 6**

PENTHOUSE - ASBESTOS ABATEMENT PLAN